

Clifton Vale Close

CLIFTON

APPROXIMATE FLOOR AREA

55.9 SQM / 602 SQFT

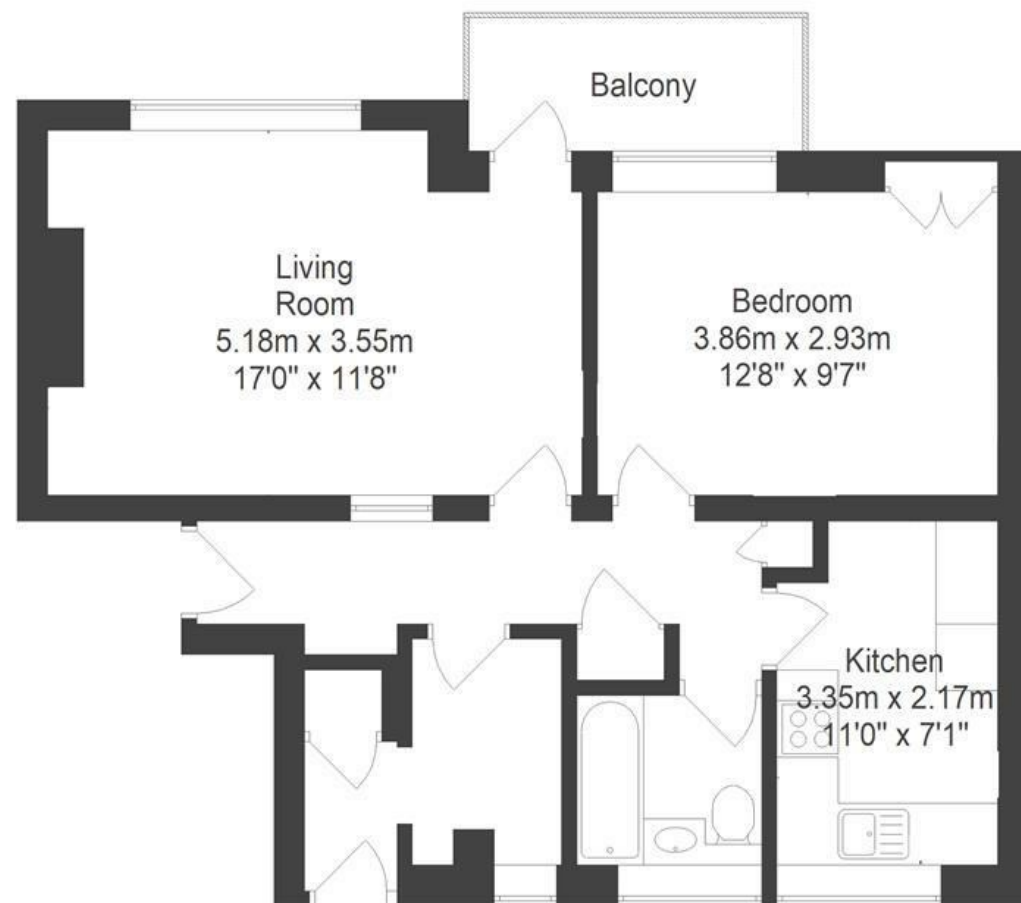

Boardwalk

Clifton Vale

, BRISTOL



£240,000



1 Bedrooms



BS8 4PX



1 Bathrooms

"I've really loved living here. It's so close to both Clifton Village and The Harbourside I'm spoilt for choice on an evening or weekend as to which direction to head in. I've enjoyed the South facing terrace and the open space in front of the flat, it's really great when the sun's out. It's time to move on but I do so with so many fond memories."

